

This drawing is the property of Pacific Mobile Structures, Inc. and may not be duplicated without approval. Actual features may vary due to available inventory.

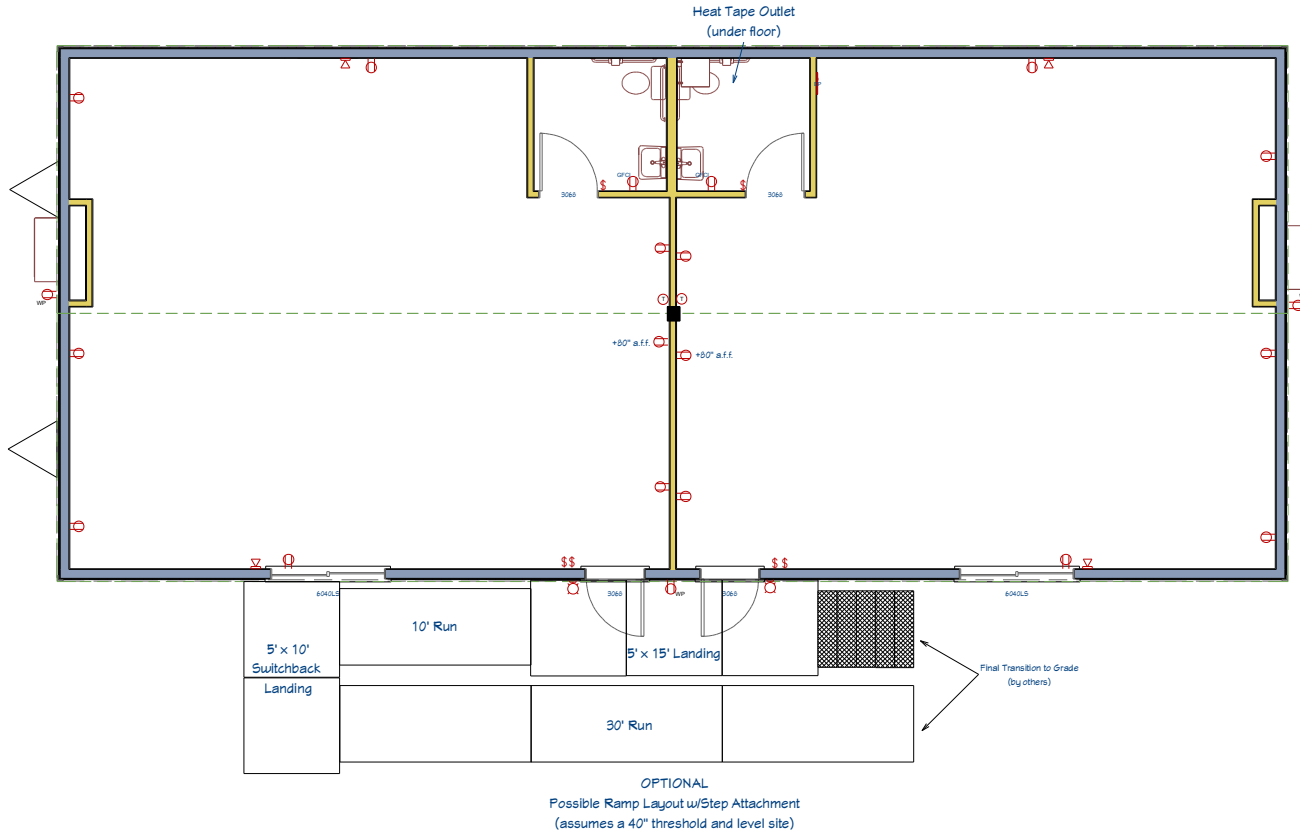

FEATURES

- Outrigger Chassis w/hitch
- VCT Flooring w/4" vinyl base
- Vinyl wrapped interior wall covering
- 8' suspended ceiling
- 2x4 troffer lights
- Endwall HVAC w/ducted supply Plenum wall ducted return
- Asphalt Shingle Roof 2:12 Slope
- LP SmartPanel siding Grey siding / Blue trim
- 6040 Horizontal sliding windows
- 3068 Painted steel exterior doors w/closer, passage, and deadbolt
- 3068 Prefinished interior doors w/Timely frame and passage

LEGEND Panel Box Porch Light Thermostat Duplex Outlet Light Switch Perm. Interior wall Temp. Interior wall Empty data box

This drawing is the property of Pacific Mobile Structures, Inc. and may not be duplicated without approval. Actual features may vary due to available inventory.

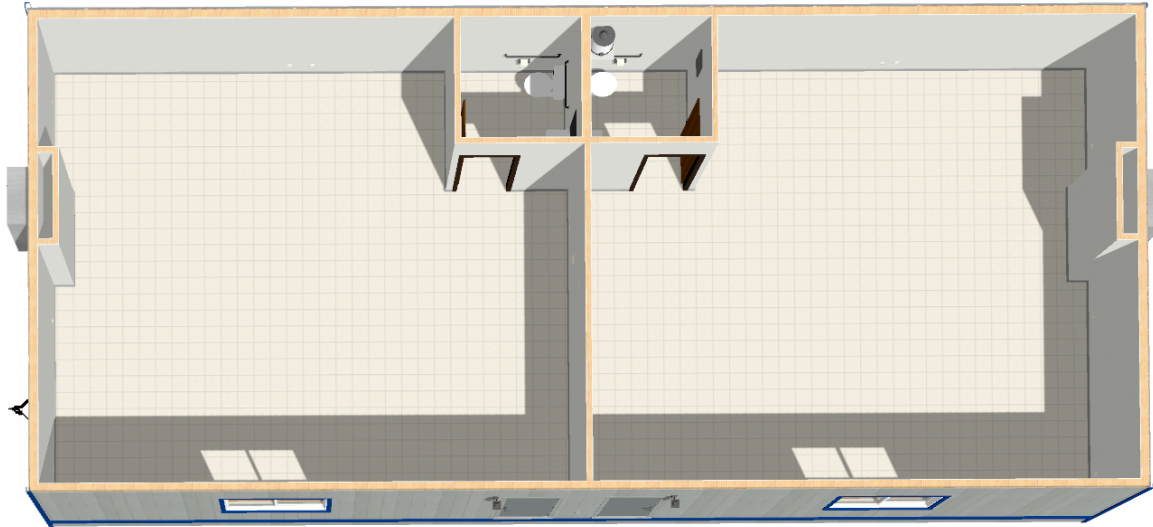

View toward the main exit door



View into restroom



Optional Skirting